

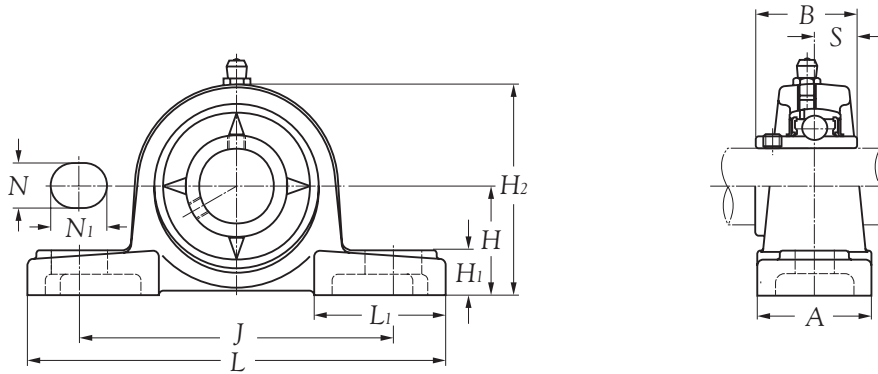

DIMENSION TABLES

PILLOW BLOCKS CAST HOUSINGS (SET SCREW TYPE)
SERIES UCP 200



| Shaft dia. mm | Unit number | Nominal dimensions | | | | | | | | | | |
|------------------|--------------------|--------------------|----------|----------|----------|----------|----------------------|----------------------|----------------------|----------------------|----------|----------|
| | | <i>H</i> | <i>L</i> | <i>J</i> | <i>A</i> | <i>N</i> | <i>N_i</i> | <i>H₁</i> | <i>H₂</i> | <i>L₁</i> | <i>B</i> | <i>S</i> |
| 12 | UCP 201 (H) | 30.2 | 127 | 95 | 38 | 13 | 16 | 14 | 62 | 42 | 31.0 | 12.7 |
| 15 | UCP 202 (H) | 30.2 | 127 | 95 | 38 | 13 | 16 | 14 | 62 | 42 | 31.0 | 12.7 |
| 17 | UCP 203 (H) | 30.2 | 127 | 95 | 38 | 13 | 16 | 14 | 62 | 42 | 31.0 | 12.7 |
| 20 | UCP 204 (H) | 33.3 | 127 | 95 | 38 | 13 | 16 | 14 | 65 | 42 | 31.0 | 12.7 |
| 25 | UCP 205 (H) | 36.5 | 140 | 105 | 38 | 13 | 16 | 15 | 71 | 42 | 34.1 | 14.3 |
| 30 | UCP 206 (H) | 42.9 | 165 | 121 | 48 | 17 | 20 | 17 | 83 | 54 | 38.1 | 15.9 |
| 35 | UCP 207 (H) | 47.6 | 167 | 127 | 48 | 17 | 20 | 18 | 93 | 54 | 42.9 | 17.5 |
| 40 | UCP 208 (H) | 49.2 | 184 | 137 | 54 | 17 | 20 | 18 | 98 | 52 | 49.2 | 19.0 |
| 45 | UCP 209 (H) | 54.0 | 190 | 146 | 54 | 17 | 20 | 20 | 106 | 60 | 49.2 | 19.0 |
| 50 | UCP 210 (H) | 57.2 | 206 | 159 | 60 | 20 | 23 | 21 | 114 | 65 | 51.6 | 19.0 |
| 55 | UCP 211 (H) | 63.5 | 219 | 171 | 60 | 20 | 23 | 23 | 126 | 65 | 55.6 | 22.2 |
| 60 | UCP 212 (H) | 69.8 | 241 | 184 | 70 | 20 | 23 | 25 | 138 | 70 | 65.1 | 25.4 |
| 65 | UCP 213 (H) | 76.2 | 265 | 203 | 70 | 25 | 28 | 27 | 151 | 77 | 65.1 | 25.4 |
| 70 | UCP 214 (H) | 79.4 | 266 | 210 | 72 | 25 | 28 | 27 | 157 | 77 | 74.6 | 30.2 |
| 75 | UCP 215 (H) | 82.6 | 275 | 217 | 74 | 25 | 28 | 28 | 163 | 80 | 77.8 | 33.3 |
| 80 | UCP 216 (H) | 88.9 | 292 | 232 | 78 | 25 | 28 | 30 | 175 | 85 | 82.6 | 33.3 |
| 85 | UCP 217 (H) | 95.2 | 310 | 247 | 83 | 25 | 28 | 32 | 187 | 85 | 85.7 | 34.1 |
| 90 | UCP 218 (H) | 101.6 | 327 | 262 | 88 | 27 | 30 | 33 | 200 | 90 | 96.0 | 39.7 |

PILLOW BLOCKS CAST HOUSINGS (SET SCREW TYPE)
SERIES UCP 200

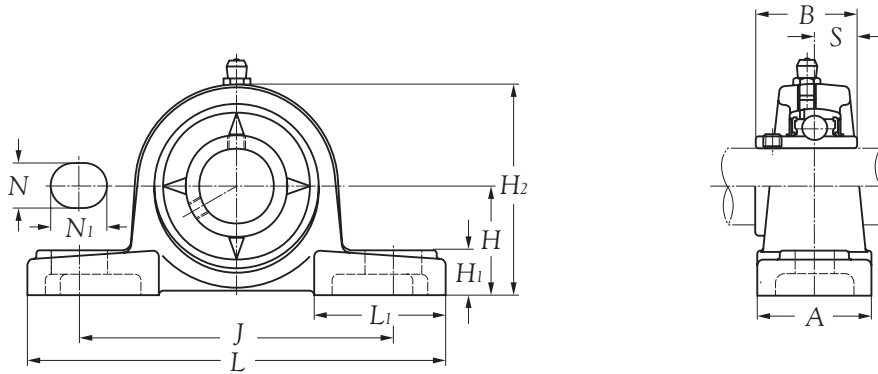

| Bolt size mm | Bearing number | Housing number | Mass of unit kg |
|-------------------------------|-----------------------|-----------------------|----------------------------------|
| M10 | UC 201 (D1) | P 201 (H) | 0.7 |
| M10 | UC 202 (D1) | P 202 (H) | 0.7 |
| M10 | UC 203 (D1) | P 203 (H) | 0.7 |
| M10 | UC 204 (D1) | P 204 (H) | 0.7 |
| M10 | UC 205 (D1) | P 205 (H) | 0.8 |
| M14 | UC 206 (D1) | P 206 (H) | 1.3 |
| M14 | UC 207 (D1) | P 207 (H) | 1.6 |
| M14 | UC 208 (D1) | P 208 (H) | 1.9 |
| M14 | UC 209 (D1) | P 209 (H) | 2.2 |
| M16 | UC 210 (D1) | P 210 (H) | 2.6 |
| M16 | UC 211 (D1) | P 211 (H) | 3.3 |
| M16 | UC 212 (D1) | P 212 (H) | 4.6 |
| M20 | UC 213 (D1) | P 213 (H) | 5.9 |
| M20 | UC 214 (D1) | P 214 (H) | 6.6 |
| M20 | UC 215 (D1) | P 215 (H) | 7.4 |
| M20 | UC 216 (D1) | P 216 (H) | 9.0 |
| M20 | UC 217 (D1) | P 217 (H) | 11.0 |
| M22 | UC 218 (D1) | P 218 (H) | 13.0 |

FLANGED UNITS CAST HOUSINGS (SET SCREW TYPE)
SERIES UCF 200

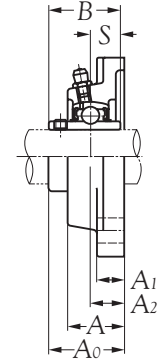
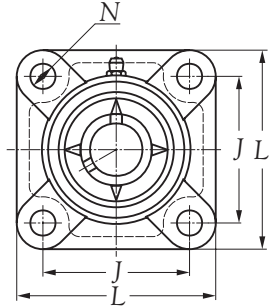

| Shaft dia. mm | Unit number | Nominal dimensions | | | | | | | | |
|------------------|--------------------|--------------------|-----|----------------|----------------|---------|----|----------------|------|------|
| | | L | J | A ₂ | A ₁ | mm A | N | A ₀ | B | S |
| 12 | UCF 201 (H) | 86 | 64 | 15 | 11 | 25.5 | 12 | 33.3 | 31.0 | 12.7 |
| 15 | UCF 202 (H) | 86 | 64 | 15 | 11 | 25.5 | 12 | 33.3 | 31.0 | 12.7 |
| 17 | UCF 203 (H) | 86 | 64 | 15 | 11 | 25.5 | 12 | 33.3 | 31.0 | 12.7 |
| 20 | UCF 204 (H) | 86 | 64 | 15 | 11 | 25.5 | 12 | 33.3 | 31.0 | 12.7 |
| 25 | UCF 205 (H) | 95 | 70 | 16 | 13 | 27.0 | 12 | 35.8 | 34.1 | 14.3 |
| 30 | UCF 206 (H) | 108 | 83 | 18 | 13 | 31.0 | 12 | 40.2 | 38.1 | 15.9 |
| 35 | UCF 207 (H) | 117 | 92 | 19 | 15 | 34.0 | 14 | 44.4 | 42.9 | 17.5 |
| 40 | UCF 208 (H) | 130 | 102 | 21 | 15 | 36.0 | 16 | 51.2 | 49.2 | 19.0 |
| 45 | UCF 209 (H) | 137 | 105 | 22 | 16 | 38.0 | 16 | 52.2 | 49.2 | 19.0 |
| 50 | UCF 210 (H) | 143 | 111 | 22 | 16 | 40.0 | 16 | 54.6 | 51.6 | 19.0 |
| 55 | UCF 211 (H) | 162 | 130 | 25 | 18 | 43.0 | 19 | 58.4 | 55.6 | 22.2 |
| 60 | UCF 212 (H) | 175 | 143 | 29 | 18 | 48.0 | 19 | 68.7 | 65.1 | 25.4 |
| 65 | UCF 213 (H) | 187 | 149 | 30 | 22 | 50.0 | 19 | 69.7 | 65.1 | 25.4 |
| 70 | UCF 214 (H) | 193 | 152 | 31 | 22 | 54.0 | 19 | 75.4 | 74.6 | 30.2 |
| 75 | UCF 215 (H) | 200 | 159 | 34 | 22 | 56.0 | 19 | 78.5 | 77.8 | 33.3 |
| 80 | UCF 216 (H) | 208 | 165 | 34 | 22 | 58.0 | 23 | 83.3 | 82.6 | 33.3 |
| 85 | UCF 217 (H) | 220 | 175 | 36 | 24 | 63.0 | 23 | 87.6 | 85.7 | 34.1 |
| 90 | UCF 218 (H) | 235 | 187 | 40 | 24 | 68.0 | 23 | 96.3 | 96.0 | 39.7 |

FLANGED UNITS CAST HOUSINGS (SET SCREW TYPE)
SERIES UCF 200

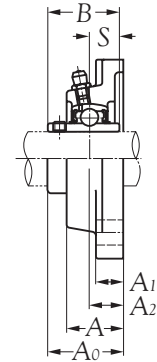
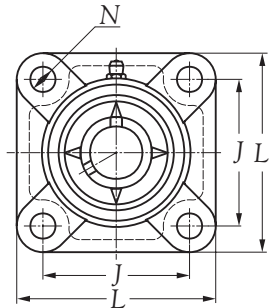

| Bolt size mm | Bearing number | Housing number | Mass of unit kg |
|-------------------------------|-----------------------|-----------------------|----------------------------------|
| M10 | UC 201 (D1) | F 204 (H) | 0.7 |
| M10 | UC 202 (D1) | F 204 (H) | 0.7 |
| M10 | UC 203 (D1) | F 204 (H) | 0.6 |
| M10 | UC 204 (D1) | F 204 (H) | 0.6 |
| M10 | UC 205 (D1) | F 205 (H) | 0.8 |
| M10 | UC 206 (D1) | F 206 (H) | 1.0 |
| M12 | UC 207 (D1) | F 207 (H) | 1.4 |
| M14 | UC 208 (D1) | F 208 (H) | 1.8 |
| M14 | UC 209 (D1) | F 209 (H) | 2.2 |
| M14 | UC 210 (D1) | F 210 (H) | 2.4 |
| M16 | UC 211 (D1) | F 211 (H) | 3.6 |
| M16 | UC 212 (D1) | F 212 (H) | 4.4 |
| M16 | UC 213 (D1) | F 213 (H) | 5.5 |
| M16 | UC 214 (D1) | F 214 (H) | 6.1 |
| M16 | UC 215 (D1) | F 215 (H) | 6.9 |
| M20 | UC 216 (D1) | F 216 (H) | 8.1 |
| M20 | UC 217 (D1) | F 217 (H) | 9.3 |
| M22 | UC 218 (D1) | F 218 (H) | 11.0 |

FLANGED UNITS CAST HOUSINGS (SET SCREW TYPE)
SERIES UCFL 200

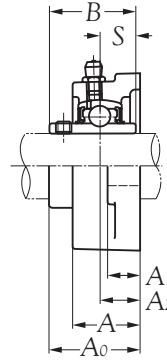
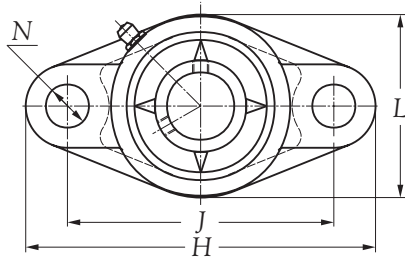

| Shaft dia. mm | Unit number | Nominal dimensions | | | | | | | | | |
|------------------|--------------|--------------------|-----|----------------|----------------|------|----|-----|----------------|------|------|
| | | H | J | A ₂ | A ₁ | A | N | L | A ₀ | B | S |
| 12 | UCFL 201 (H) | 113 | 90 | 15 | 11 | 25.5 | 12 | 60 | 33.3 | 31.0 | 12.7 |
| 15 | UCFL 202 (H) | 113 | 90 | 15 | 11 | 25.5 | 12 | 60 | 33.3 | 31.0 | 12.7 |
| 17 | UCFL 203 (H) | 113 | 90 | 15 | 11 | 25.5 | 12 | 60 | 33.3 | 31.0 | 12.7 |
| 20 | UCFL 204 (H) | 113 | 90 | 15 | 11 | 25.5 | 12 | 60 | 33.3 | 31.0 | 12.7 |
| 25 | UCFL 205 (H) | 130 | 99 | 16 | 13 | 27.0 | 16 | 68 | 35.8 | 34.1 | 14.3 |
| 30 | UCFL 206 (H) | 148 | 117 | 18 | 13 | 31.0 | 16 | 80 | 40.2 | 38.1 | 15.9 |
| 35 | UCFL 207 (H) | 161 | 130 | 19 | 15 | 34.0 | 16 | 90 | 44.4 | 42.9 | 17.5 |
| 40 | UCFL 208 (H) | 175 | 144 | 21 | 15 | 36.0 | 16 | 100 | 51.2 | 49.2 | 19.0 |
| 45 | UCFL 209 (H) | 188 | 148 | 22 | 16 | 38.0 | 19 | 108 | 52.2 | 49.2 | 19.0 |
| 50 | UCFL 210 (H) | 197 | 157 | 22 | 16 | 40.0 | 19 | 115 | 54.6 | 51.6 | 19.0 |
| 55 | UCFL 211 (H) | 224 | 184 | 25 | 18 | 43.0 | 19 | 130 | 58.4 | 55.6 | 22.2 |
| 60 | UCFL 212 (H) | 250 | 202 | 29 | 18 | 48.0 | 23 | 140 | 68.7 | 65.1 | 25.4 |
| 65 | UCFL 213 (H) | 258 | 210 | 30 | 22 | 50.0 | 23 | 155 | 69.7 | 65.1 | 25.4 |
| 70 | UCFL 214 (H) | 265 | 216 | 31 | 22 | 54.0 | 23 | 160 | 75.4 | 74.6 | 30.2 |
| 75 | UCFL 215 (H) | 275 | 225 | 34 | 22 | 56.0 | 23 | 165 | 78.5 | 77.8 | 33.3 |
| 80 | UCFL 216 (H) | 290 | 233 | 34 | 22 | 58.0 | 25 | 180 | 83.3 | 82.6 | 33.3 |
| 85 | UCFL 217 (H) | 305 | 248 | 36 | 24 | 63.0 | 25 | 190 | 87.6 | 85.7 | 34.1 |
| 90 | UCFL 218 (H) | 320 | 265 | 40 | 24 | 68.0 | 25 | 205 | 96.3 | 96.0 | 39.7 |

FLANGED UNITS CAST HOUSINGS (SET SCREW TYPE)
SERIES UCFL 200

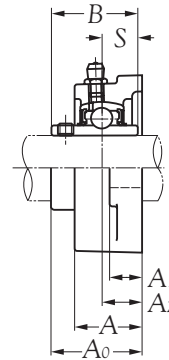
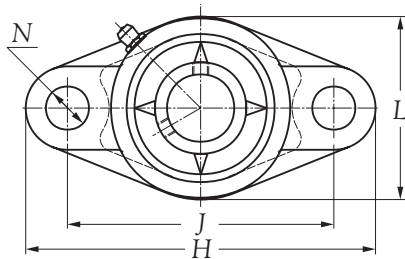

| Bolt size mm | Bearing number | Housing number | Mass of unit kg |
|-----------------|----------------|----------------|--------------------|
| M10 | UC 201 (D1) | FL 204 (H) | 0.6 |
| M10 | UC 202 (D1) | FL 204 (H) | 0.6 |
| M10 | UC 203 (D1) | FL 204 (H) | 0.6 |
| M10 | UC 204 (D1) | FL 204 (H) | 0.6 |
| M14 | UC 205 (D1) | FL 205 (H) | 0.6 |
| M14 | UC 206 (D1) | FL 206 (H) | 0.9 |
| M14 | UC 207 (D1) | FL 207 (H) | 1.2 |
| M14 | UC 208 (D1) | FL 208 (H) | 1.6 |
| M16 | UC 209 (D1) | FL 209 (H) | 1.9 |
| M16 | UC 210 (D1) | FL 210 (H) | 2.2 |
| M16 | UC 211 (D1) | FL 211 (H) | 3.1 |
| M20 | UC 212 (D1) | FL 212 (H) | 4.0 |
| M20 | UC 213 (D1) | FL 213 (H) | 5.0 |
| M20 | UC 214 (D1) | FL 214 (H) | 5.6 |
| M20 | UC 215 (D1) | FL 215 (H) | 6.2 |
| M22 | UC 216 (D1) | FL 216 (H) | 8.2 |
| M22 | UC 217 (D1) | FL 217 (H) | 9.3 |
| M22 | UC 218 (D1) | FL 218 (H) | 11.0 |

FLANGED CARTRIDGE UNITS CAST HOUSINGS (SET SCREW TYPE)
SERIES UCFC 200

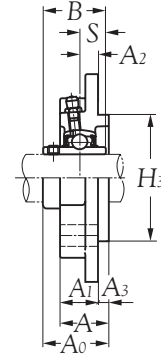
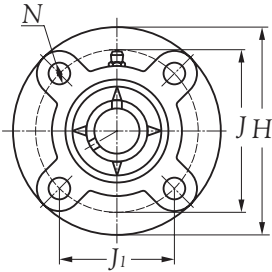

| Shaft dia. mm | Unit number | Nominal dimensions | | | | | | | | | | | |
|------------------|--------------|--------------------|-----|----------------|----------------|----|----------------|----------------|------|----------------|----------------|------|------|
| | | H | J | J ₁ | A ₂ | N | A ₃ | A ₁ | A | H ₃ | A ₀ | B | S |
| 12 | UCFC 201 (H) | 100 | 78 | 55.1 | 10 | 12 | 5 | 20.5 | 25.5 | 62 | 33.3 | 31.0 | 12.7 |
| 15 | UCFC 202 (H) | 100 | 78 | 55.1 | 10 | 12 | 5 | 20.5 | 25.5 | 62 | 33.3 | 31.0 | 12.7 |
| 17 | UCFC 203 (H) | 100 | 78 | 55.1 | 10 | 12 | 5 | 20.5 | 25.5 | 62 | 33.3 | 31.0 | 12.7 |
| 20 | UCFC 204 (H) | 100 | 78 | 55.1 | 10 | 12 | 5 | 20.5 | 25.5 | 62 | 33.3 | 31.0 | 12.7 |
| 25 | UCFC 205 (H) | 115 | 90 | 63.6 | 10 | 12 | 6 | 21.0 | 27.0 | 70 | 35.8 | 34.1 | 14.3 |
| 30 | UCFC 206 (H) | 125 | 100 | 70.7 | 10 | 12 | 8 | 23.0 | 31.0 | 80 | 40.2 | 38.1 | 15.9 |
| 35 | UCFC 207 (H) | 135 | 110 | 77.8 | 11 | 14 | 8 | 26.0 | 34.0 | 90 | 44.4 | 42.9 | 17.5 |
| 40 | UCFC 208 (H) | 145 | 120 | 84.8 | 11 | 14 | 10 | 26.0 | 36.0 | 100 | 51.2 | 49.2 | 19.0 |
| 45 | UCFC 209 (H) | 160 | 132 | 93.3 | 10 | 16 | 12 | 26.0 | 38.0 | 105 | 52.2 | 49.2 | 19.0 |
| 50 | UCFC 210 (H) | 165 | 138 | 97.6 | 10 | 16 | 12 | 28.0 | 40.0 | 110 | 54.6 | 51.6 | 19.0 |
| 55 | UCFC 211 (H) | 185 | 150 | 106.1 | 13 | 19 | 12 | 31.0 | 43.0 | 125 | 58.4 | 55.6 | 22.2 |
| 60 | UCFC 212 (H) | 195 | 160 | 113.1 | 17 | 19 | 12 | 36.0 | 48.0 | 135 | 68.7 | 65.1 | 25.4 |
| 65 | UCFC 213 (H) | 205 | 170 | 120.2 | 16 | 19 | 14 | 36.0 | 50.0 | 145 | 69.7 | 65.1 | 25.4 |
| 70 | UCFC 214 (H) | 215 | 177 | 125.1 | 17 | 19 | 14 | 40.0 | 44.0 | 150 | 75.4 | 74.6 | 30.2 |
| 75 | UCFC 215 (H) | 220 | 184 | 130.1 | 18 | 19 | 16 | 40.0 | 56.0 | 160 | 78.5 | 77.8 | 33.3 |
| 80 | UCFC 216 (H) | 240 | 200 | 141.4 | 18 | 23 | 16 | 42.0 | 58.0 | 170 | 83.3 | 82.6 | 33.3 |
| 85 | UCFC 217 (H) | 250 | 208 | 147.1 | 18 | 23 | 18 | 45.0 | 63.0 | 180 | 87.6 | 85.7 | 34.1 |
| 90 | UCFC 218 (H) | 265 | 220 | 155.5 | 22 | 23 | 18 | 50.0 | 68.0 | 190 | 96.3 | 96.0 | 39.7 |

FLANGED CARTRIDGE UNITS CAST HOUSINGS (SET SCREW TYPE)
SERIES UCFC 200

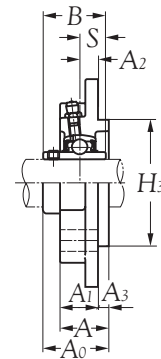
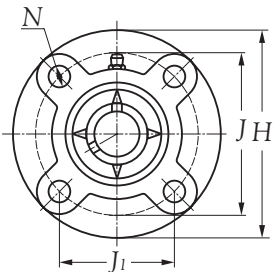

| Bolt size mm | Bearing number | Housing number | Mass of unit kg |
|-------------------------|-----------------------|-----------------------|----------------------------|
| M10 | UC 201 (D1) | FC 204 (H) | 0.8 |
| M10 | UC 202 (D1) | FC 204 (H) | 0.8 |
| M10 | UC 203 (D1) | FC 204 (H) | 0.8 |
| M10 | UC 204 (D1) | FC 204 (H) | 0.8 |
| M10 | UC 205 (D1) | FC 205 (H) | 1.0 |
| M10 | UC 206 (D1) | FC 206 (H) | 1.3 |
| M12 | UC 207 (D1) | FC 207 (H) | 1.6 |
| M12 | UC 208 (D1) | FC 208 (H) | 2.1 |
| M14 | UC 209 (D1) | FC 209 (H) | 2.7 |
| M14 | UC 210 (D1) | FC 210 (H) | 3.1 |
| M16 | UC 211 (D1) | FC 211 (H) | 4.2 |
| M16 | UC 212 (D1) | FC 212 (H) | 5.3 |
| M16 | UC 213 (D1) | FC 213 (H) | 6.0 |
| M16 | UC 214 (D1) | FC 214 (H) | 7.0 |
| M16 | UC 215 (D1) | FC 215 (H) | 7.8 |
| M20 | UC 216 (D1) | FC 216 (H) | 9.3 |
| M20 | UC 217 (D1) | FC 217 (H) | 11.0 |
| M20 | UC 218 (D1) | FC 218 (H) | 13.0 |

TAKE-UP UNITS CAST HOUSINGS (SET SCREW TYPE)
SERIES UCT 200

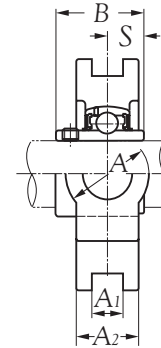
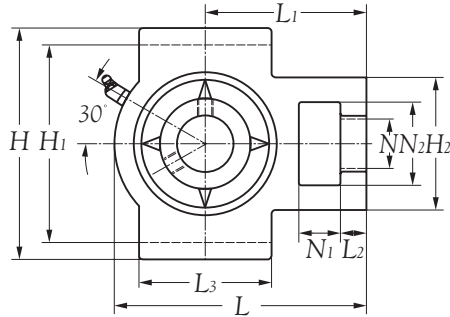

| Shaft dia. mm | Unit number | Nominal dimensions | | | | | | | | | | | | | | | |
|------------------|--------------------|--------------------|-------|-------|-------|-----|-------|-------|-------|-----|-----|-------|-----|-----|-------|------|------|
| | | mm | | | | | | | | | | | | | | | |
| | | N_1 | L_2 | H_2 | N_2 | N | L_3 | A_1 | H_1 | H | L | A_2 | A | r | L_1 | B | S |
| 12 | UCT 201 (H) | 16 | 12 | 51 | 32 | 19 | 51 | 12 | 76 | 89 | 94 | 21 | 32 | 33 | 61 | 31.0 | 12.7 |
| 15 | UCT 202 (H) | 16 | 12 | 51 | 32 | 19 | 51 | 12 | 76 | 89 | 94 | 21 | 32 | 33 | 61 | 31.0 | 12.7 |
| 17 | UCT 203 (H) | 16 | 12 | 51 | 32 | 19 | 51 | 12 | 76 | 89 | 94 | 21 | 32 | 33 | 61 | 31.0 | 12.7 |
| 20 | UCT 204 (H) | 16 | 12 | 51 | 32 | 19 | 51 | 12 | 76 | 89 | 94 | 21 | 32 | 33 | 61 | 31.0 | 12.7 |
| 25 | UCT 205 (H) | 16 | 12 | 51 | 32 | 19 | 51 | 12 | 76 | 89 | 97 | 24 | 32 | 35 | 62 | 34.1 | 14.3 |
| 30 | UCT 206 (H) | 16 | 12 | 56 | 37 | 22 | 57 | 12 | 89 | 102 | 113 | 28 | 37 | 43 | 70 | 38.1 | 15.9 |
| 35 | UCT 207 (H) | 16 | 15 | 64 | 37 | 22 | 64 | 12 | 89 | 102 | 129 | 30 | 37 | 51 | 78 | 42.9 | 17.5 |
| 40 | UCT 208 (H) | 19 | 18 | 83 | 49 | 29 | 83 | 16 | 102 | 114 | 144 | 33 | 49 | 56 | 88 | 49.2 | 19.0 |
| 45 | UCT 209 (H) | 19 | 18 | 83 | 49 | 29 | 83 | 16 | 102 | 117 | 145 | 35 | 49 | 57 | 88 | 49.2 | 19.0 |
| 50 | UCT 210 (H) | 19 | 18 | 83 | 49 | 29 | 86 | 16 | 102 | 117 | 151 | 37 | 49 | 59 | 92 | 51.6 | 19.0 |
| 55 | UCT 211 (H) | 25 | 21 | 102 | 64 | 35 | 95 | 22 | 130 | 146 | 171 | 38 | 64 | 65 | 106 | 55.6 | 22.2 |
| 60 | UCT 212 (H) | 32 | 21 | 102 | 64 | 35 | 102 | 22 | 130 | 146 | 194 | 42 | 64 | 75 | 119 | 65.1 | 25.4 |
| 65 | UCT 213 (H) | 32 | 23 | 111 | 70 | 41 | 121 | 26 | 151 | 167 | 224 | 44 | 70 | 87 | 137 | 65.1 | 25.4 |
| 70 | UCT 214 (H) | 32 | 23 | 111 | 70 | 41 | 121 | 26 | 151 | 167 | 224 | 46 | 70 | 87 | 137 | 74.6 | 30.2 |
| 75 | UCT 215 (H) | 32 | 23 | 111 | 70 | 41 | 121 | 26 | 151 | 167 | 232 | 48 | 70 | 92 | 140 | 77.8 | 33.3 |
| 80 | UCT 216 (H) | 32 | 23 | 111 | 70 | 41 | 121 | 26 | 165 | 184 | 235 | 51 | 70 | 95 | 140 | 82.6 | 33.3 |
| 85 | UCT 217 (H) | 38 | 31 | 124 | 73 | 48 | 157 | 30 | 173 | 198 | 260 | 54 | 73 | 98 | 162 | 85.7 | 34.1 |

TAKE-UP UNITS CAST HOUSINGS (SET SCREW TYPE)
SERIES UCT 200

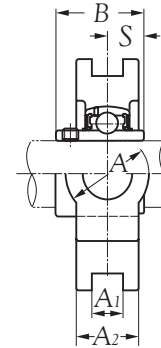
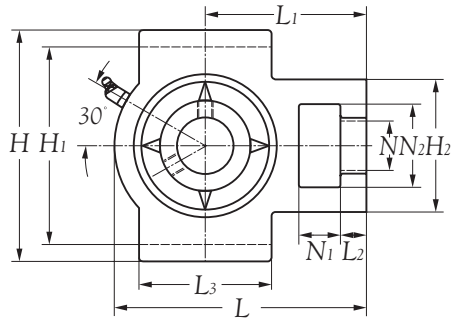

| Bearing number | Housing number | Mass of unit kg |
|----------------|----------------|--------------------|
| UC 201 (D1) | T 204 (H) | 0.8 |
| UC 202 (D1) | T 204 (H) | 0.8 |
| UC 203 (D1) | T 204 (H) | 0.8 |
| UC 204 (D1) | T 204 (H) | 0.8 |
| UC 205 (D1) | T 205 (H) | 0.9 |
| UC 206 (D1) | T 206 (H) | 1.3 |
| UC 207 (D1) | T 207 (H) | 1.7 |
| UC 208 (D1) | T 208 (H) | 2.3 |
| UC 209 (D1) | T 209 (H) | 2.4 |
| UC 210 (D1) | T 210 (H) | 2.5 |
| UC 211 (D1) | T 211 (H) | 3.8 |
| UC 212 (D1) | T 212 (H) | 4.7 |
| UC 213 (D1) | T 213 (H) | 7.0 |
| UC 214 (D1) | T 214 (H) | 7.3 |
| UC 215 (D1) | T 215 (H) | 7.7 |
| UC 216 (D1) | T 216 (H) | 8.4 |
| UC 217 (D1) | T 217 (H) | 11.0 |

PILLOW BLOCKS CAST HOUSINGS (SET SCREW TYPE)
SERIES UCUP 200

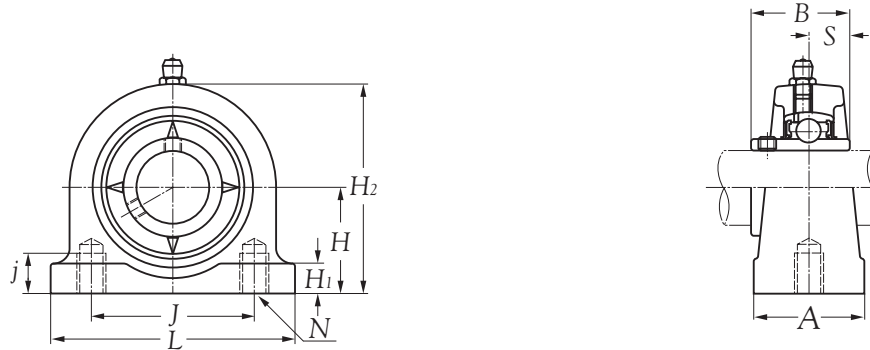

| Shaft dia. mm | Unit number | Nominal dimensions | | | | | | | | | |
|------------------|---------------------|--------------------|-----|----|----|---------|----|-----|------|------|--|
| | | H | L | J | A | mm j | H1 | H2 | B | S | |
| 12 | UCUP 201 (H) | 30.2 | 76 | 52 | 38 | 13 | 11 | 62 | 31.0 | 12.7 | |
| 15 | UCUP 202 (H) | 30.2 | 76 | 52 | 38 | 13 | 11 | 62 | 31.0 | 12.7 | |
| 17 | UCUP 203 (H) | 30.2 | 76 | 52 | 38 | 13 | 11 | 62 | 31.0 | 12.7 | |
| 20 | UCUP 204 (H) | 30.2 | 76 | 52 | 38 | 13 | 11 | 62 | 31.0 | 12.7 | |
| 25 | UCUP 205 (H) | 36.5 | 84 | 56 | 38 | 15 | 12 | 72 | 34.1 | 14.3 | |
| 30 | UCUP 206 (H) | 42.9 | 94 | 66 | 48 | 18 | 12 | 84 | 38.1 | 15.9 | |
| 35 | UCUP 207 (H) | 47.6 | 110 | 80 | 48 | 20 | 13 | 95 | 42.9 | 17.5 | |
| 40 | UCUP 208 (H) | 49.2 | 116 | 84 | 54 | 20 | 13 | 100 | 49.2 | 19.0 | |
| 45 | UCUP 209 (H) | 54.2 | 120 | 90 | 54 | 25 | 13 | 108 | 49.2 | 19.0 | |
| 50 | UCUP 210 (H) | 57.2 | 130 | 94 | 60 | 25 | 14 | 116 | 51.6 | 19.0 | |

PILLOW BLOCKS CAST HOUSINGS (SET SCREW TYPE)
SERIES UCUP 200

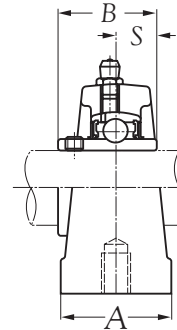
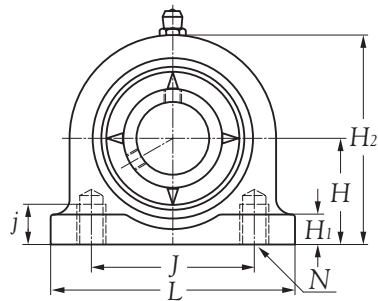

| N | Bearing number | Housing number | Mass of unit |
|---------|--------------------|-------------------|--------------|
| | | | kg |
| M10x1.5 | UC 201 (D1) | UP 204 (H) | 0.6 |
| M10x1.5 | UC 202 (D1) | UP 204 (H) | 0.6 |
| M10x1.5 | UC 203 (D1) | UP 204 (H) | 0.6 |
| M10x1.5 | UC 204 (D1) | UP 204 (H) | 0.6 |
| M10x1.5 | UC 205 (D1) | UP 205 (H) | 0.8 |
| M14x2 | UC 206 (D1) | UP 206 (H) | 1.2 |
| M14x2 | UC 207 (D1) | UP 207 (H) | 1.7 |
| M14x2 | UC 208 (D1) | UP 208 (H) | 2.0 |
| M14x2 | UC 209 (D1) | UP 209 (H) | 2.2 |
| M16x2 | UC 210 (D1) | UP 210 (H) | 2.9 |

BALL BEARINGS (SET SCREW TYPE)
SERIES UC 200

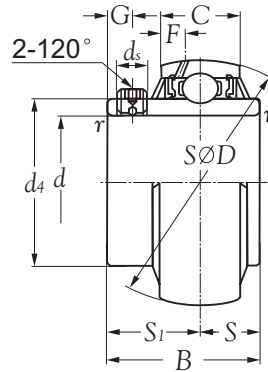

| Shaft dia. mm | Unit number | Nominal dimensions | | | | | | | | | | | Basic load ratings | | Mass kg |
|------------------|-------------|--------------------|-----|------|-----|-------|------|-------|------|----------|-------|------|-----------------------|-------------------------|------------|
| | | d | D | B | C | r_s | S | S_1 | G | d_s | d_4 | F | N dynamic C_r | N static C_{or} | |
| 12 | UC 201 (D1) | 12 | 47 | 31.0 | 17 | 0.6 | 12.7 | 18.3 | 4.5 | M5x0.8 | 29.6 | 4.7 | 12800 | 6650 | 0.21 |
| 15 | UC 202 (D1) | 15 | 47 | 31.0 | 17 | 0.6 | 12.7 | 18.3 | 4.5 | M5x0.8 | 29.6 | 4.7 | 12800 | 6650 | 0.20 |
| 17 | UC 203 (D1) | 17 | 47 | 31.0 | 17 | 0.6 | 12.7 | 18.3 | 4.5 | M5x0.8 | 29.6 | 4.7 | 12800 | 6650 | 0.18 |
| 20 | UC 204 (D1) | 20 | 47 | 31.0 | 17 | 1.0 | 12.7 | 18.3 | 4.5 | M5x0.8 | 29.6 | 4.7 | 12800 | 6650 | 0.17 |
| 25 | UC 205 (D1) | 25 | 52 | 34.1 | 17 | 1.0 | 14.3 | 19.8 | 5.0 | M5x0.8 | 33.9 | 4.5 | 14000 | 7850 | 0.20 |
| 30 | UC 206 (D1) | 30 | 62 | 38.1 | 19 | 1.0 | 15.9 | 22.2 | 5.0 | M6x0.75 | 40.8 | 4.6 | 19500 | 11300 | 0.33 |
| 35 | UC 207 (D1) | 35 | 72 | 42.9 | 20 | 1.5 | 17.5 | 25.4 | 6.0 | M6x0.75 | 46.8 | 4.6 | 25700 | 15300 | 0.49 |
| 40 | UC 208 (D1) | 40 | 80 | 49.2 | 21 | 1.5 | 19.0 | 30.2 | 8.0 | M8x1 | 53.0 | 4.5 | 29100 | 17800 | 0.65 |
| 45 | UC 209 (D1) | 45 | 85 | 49.2 | 22 | 1.5 | 19.0 | 30.2 | 8.0 | M8x1 | 57.5 | 4.9 | 32500 | 20400 | 0.70 |
| 50 | UC 210 (D1) | 50 | 90 | 51.6 | 24 | 1.5 | 19.0 | 32.6 | 9.0 | M8x1 | 62.4 | 5.9 | 35000 | 23200 | 0.80 |
| 55 | UC 211 (D1) | 55 | 100 | 55.6 | 25 | 2.0 | 22.2 | 33.4 | 9.0 | M8x1 | 69.0 | 6.0 | 43500 | 29200 | 1.08 |
| 60 | UC 212 (D1) | 60 | 110 | 65.1 | 27 | 2.0 | 25.4 | 39.7 | 10.0 | M10x1.25 | 77.0 | 6.2 | 52500 | 36000 | 1.53 |
| 65 | UC 213 (D1) | 65 | 120 | 65.1 | 32 | 2.0 | 25.4 | 39.7 | 10.0 | M10x1.25 | 82.5 | 8.7 | 57500 | 40000 | 1.85 |
| 70 | UC 214 (D1) | 70 | 125 | 74.6 | 33 | 2.0 | 30.2 | 44.4 | 12.0 | M10x1.25 | 87.0 | 8.8 | 62000 | 44000 | 2.10 |
| 75 | UC 215 (D1) | 75 | 130 | 77.8 | 34 | 2.0 | 33.3 | 44.5 | 12.0 | M10x1.25 | 93.0 | 9.0 | 66000 | 49500 | 2.35 |
| 80 | UC 216 (D1) | 80 | 140 | 82.6 | 35 | 2.5 | 33.3 | 49.3 | 12.0 | M10x1.25 | 98.1 | 9.5 | 72500 | 53000 | 2.80 |
| 85 | UC 217 (D1) | 85 | 150 | 85.7 | 36 | 2.5 | 34.1 | 51.6 | 12.0 | M12x1.5 | 106.4 | 10.1 | 83500 | 64000 | 3.37 |
| 90 | UC 218 (D1) | 90 | 160 | 96.0 | 37 | 2.5 | 39.7 | 56.3 | 12.0 | M12x1.5 | 111.6 | 9.8 | 96000 | 71500 | 4.36 |

Note: It's applied to assemble with **NIKO** housings P, F, FL, FC, T and UP.

BALL BEARINGS (ECCENTRIC LOCKING COLLAR TYPE)
SERIES AEL 200

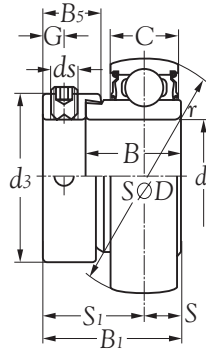

| Shaft dia. mm | Unit number | Nominal dimensions | | | | | | | | | | | Basic load ratings | | Mass kg | |
|------------------|--------------------|--------------------|----------|-----------------------|----------|----------|-----------------------|----------|-----------------------|----------|-----------------------|-----------------------|-----------------------|--------------------------------|------------|--------------------------------|
| | | <i>d</i> | <i>D</i> | <i>B</i> ₁ | <i>B</i> | <i>C</i> | <i>r</i> _s | <i>S</i> | <i>S</i> ₁ | <i>G</i> | <i>d</i> _s | <i>d</i> ₃ | <i>B</i> ₅ | N dynamic C _r | | N static C _{0r} |
| 12 | AEL201 (D1) | 12 | 40 | 28.6 | 19.0 | 12 | 0.6 | 6.5 | 22.1 | 4.8 | M6x0.75 | 29.0 | 13.6 | 9600 | 4600 | 0.12 |
| 15 | AEL202 (D1) | 15 | 40 | 28.6 | 19.0 | 12 | 0.6 | 6.5 | 22.1 | 4.8 | M6x0.75 | 29.0 | 13.6 | 9600 | 4600 | 0.11 |
| 17 | AEL203 (D1) | 17 | 40 | 28.6 | 19.0 | 12 | 0.6 | 6.5 | 22.1 | 4.8 | M6x0.75 | 29.0 | 13.6 | 9600 | 4600 | 0.10 |
| 20 | AEL204 (D1) | 20 | 47 | 31.0 | 21.5 | 14 | 1.0 | 7.5 | 23.5 | 4.8 | M6x0.75 | 33.0 | 13.5 | 12800 | 6650 | 0.17 |
| 25 | AEL205 (D1) | 25 | 52 | 31.0 | 21.5 | 15 | 1.0 | 7.5 | 23.5 | 4.8 | M6x0.75 | 38.0 | 13.5 | 14000 | 7850 | 0.20 |
| 30 | AEL206 (D1) | 30 | 62 | 35.7 | 23.8 | 16 | 1.0 | 9.0 | 26.7 | 6.0 | M8x1 | 44.5 | 15.9 | 19500 | 11300 | 0.31 |
| 35 | AEL207 (D1) | 35 | 72 | 38.9 | 25.4 | 17 | 1.5 | 9.5 | 29.4 | 6.8 | M10x1.25 | 55.5 | 17.5 | 25700 | 15300 | 0.49 |
| 40 | AEL208 (D1) | 40 | 80 | 43.7 | 30.2 | 18 | 1.5 | 11.0 | 32.7 | 6.8 | M10x1.25 | 60.0 | 18.3 | 29100 | 17800 | 0.66 |

BALL BEARINGS (SET SCREW TYPE)
SERIES AS 200

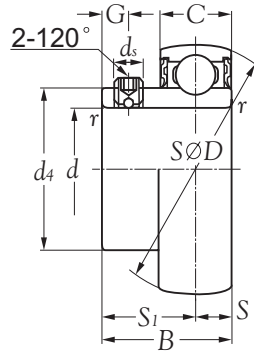

| Shaft dia. mm | Unit number | Nominal dimensions | | | | | | | | | | Basic load ratings | | Mass kg |
|------------------|--------------------|--------------------|-----|-----|-----|-------|-----|-------|-----|---------|-------|--------------------|--------------------|------------|
| | | d | D | B | C | r_s | S | S_1 | G | d_s | d_4 | dynamic C_r | static C_{or} | |
| 12 | AS 201 (D1) | 12 | 40 | 22 | 12 | 0.6 | 6.0 | 16.0 | 4.2 | M5x0.8 | 24.3 | 9600 | 4600 | 0.10 |
| 15 | AS 202 (D1) | 15 | 40 | 22 | 12 | 0.6 | 6.0 | 16.0 | 4.2 | M5x0.8 | 24.3 | 9600 | 4600 | 0.09 |
| 17 | AS 203 (D1) | 17 | 40 | 22 | 12 | 0.6 | 6.0 | 16.0 | 4.2 | M5x0.8 | 24.3 | 9600 | 4600 | 0.08 |
| 20 | AS 204 (D1) | 20 | 47 | 25 | 14 | 1.0 | 7.0 | 18.0 | 4.2 | M5x0.8 | 29.6 | 12800 | 6650 | 0.13 |
| 25 | AS 205 (D1) | 25 | 52 | 27 | 15 | 1.0 | 7.5 | 19.5 | 5.0 | M5x0.8 | 33.9 | 14000 | 7850 | 0.16 |
| 30 | AS 206 (D1) | 30 | 62 | 29 | 16 | 1.0 | 8.0 | 21.0 | 5.0 | M6x0.75 | 40.8 | 19500 | 11300 | 0.25 |
| 35 | AS 207 (D1) | 35 | 72 | 34 | 17 | 1.5 | 8.5 | 25.5 | 6.0 | M6x0.75 | 46.8 | 25700 | 15300 | 0.37 |
| 40 | AS 208 (D1) | 40 | 80 | 38 | 18 | 1.5 | 9.0 | 29.0 | 8.0 | M8x1 | 53.0 | 29100 | 17800 | 0.50 |

**BALL BEARINGS (ADAPTER TYPE)
SERIES UK 200**

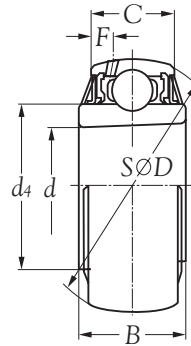
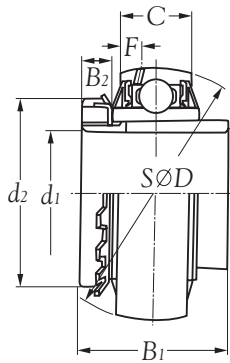

Taper 1:12

| Shaft dia. mm | Unit number | Nominal dimensions | | | | | | | | | | Basic load ratings | | Mass kg |
|------------------|--------------------|--------------------|-----|-----|-----|-------|-------|-------|-------|-------|-----|--------------------|--------------------|------------|
| | | mm | | | | | | | | | | N | | |
| | | d | D | B | C | d_4 | d_1 | B_1 | B_2 | d_2 | F | dynamic C_r | static C_{or} | |
| 20 | UK 205 (D1) | 25 | 52 | 23 | 17 | 33.9 | 20 | 35 | 8 | 38 | 4.5 | 14000 | 7850 | 0.25 |
| 25 | UK 206 (D1) | 30 | 62 | 26 | 19 | 40.8 | 25 | 38 | 8 | 45 | 4.6 | 19500 | 11300 | 0.36 |
| 30 | UK 207 (D1) | 35 | 72 | 29 | 20 | 46.8 | 30 | 43 | 9 | 52 | 4.6 | 25700 | 15300 | 0.57 |
| 35 | UK 208 (D1) | 40 | 80 | 31 | 21 | 53.0 | 35 | 46 | 10 | 58 | 4.5 | 29100 | 17800 | 0.74 |
| 40 | UK 209 (D1) | 45 | 85 | 31 | 22 | 57.5 | 40 | 50 | 11 | 65 | 4.9 | 32500 | 20400 | 0.83 |
| 45 | UK 210 (D1) | 50 | 90 | 32 | 24 | 62.4 | 45 | 55 | 12 | 70 | 5.9 | 35000 | 23200 | 0.97 |
| 50 | UK 211 (D1) | 55 | 100 | 35 | 25 | 69.0 | 50 | 59 | 12 | 75 | 6.0 | 43500 | 29200 | 1.26 |
| 55 | UK 212 (D1) | 60 | 110 | 38 | 27 | 77.0 | 55 | 62 | 13 | 80 | 6.2 | 52500 | 36000 | 1.59 |
| 60 | UK 213 (D1) | 65 | 120 | 40 | 32 | 82.5 | 60 | 65 | 14 | 85 | 8.7 | 57500 | 40000 | 2.00 |
| 65 | UK 215 (D1) | 75 | 130 | 44 | 34 | 93.0 | 65 | 73 | 15 | 98 | 9.0 | 66000 | 49500 | 2.56 |
| 70 | UK 216 (D1) | 80 | 140 | 45 | 35 | 98.1 | 70 | 78 | 17 | 105 | 9.5 | 72500 | 53000 | 3.23 |



Bearing Units

Using applications

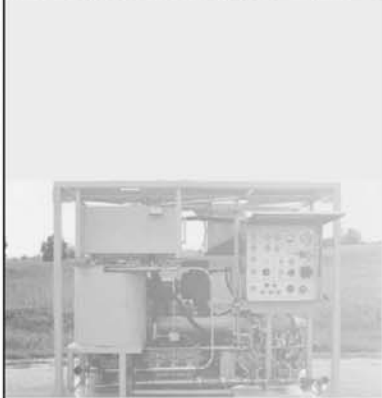

- Extruder gearbox
- Bevel gearbox
- Small electric motor
- Electric car motor
- Research vessel "M/V OCEAN Explorer"
- Concrete pipe production
- Jachmann bridge
- Tennis stadium
- Bascule bridge
- Belt conveyor system
- Analytical instrument
- Refraction unit
- Urology instrument
- Handling robot
- Lorry-mounted crane
- Plastic blow moulding machine
- Injection moulding machine
- Calender
- Cut-off valve
- Rodless pneumatic cylinder
- Radial piston motor
- Garden secateurs
- Hay tedding machine
- Automatic assembly machine
- Cabriolet
- Passenger car steering bearings
- Cross-cut and mitre-box saw
- Rail vehicle tilt system
- Tram
- Metro train
- Fitness training machine
- Roller or in-line skates
- Continuous casting machine
- Power saw
- Machining centre
- Front-operated lathe
- Deep hole drilling machine
- Sheetfed offset printing press
- All-purpose food slicer

